

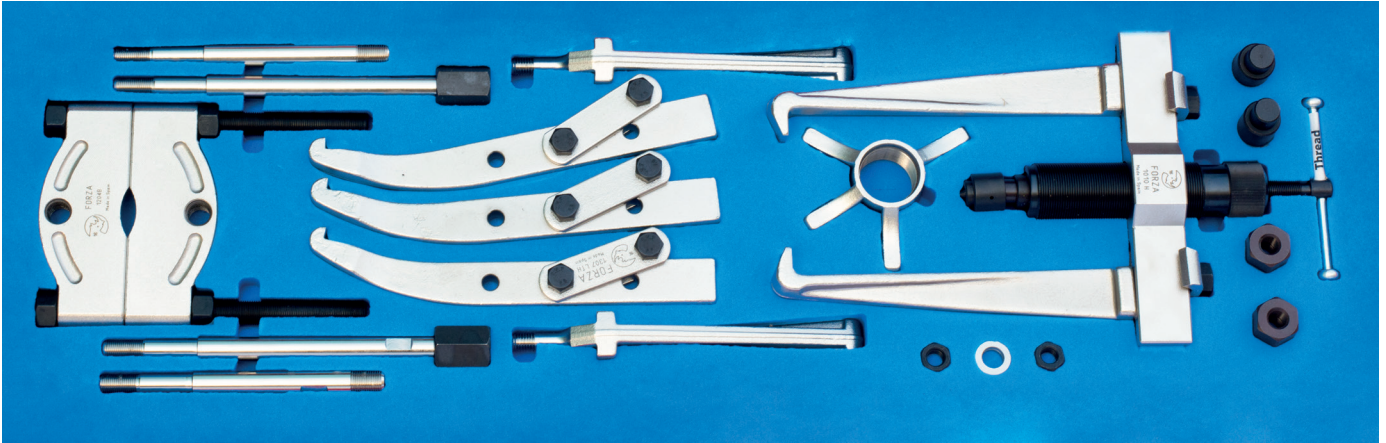

8 Ton Kapasiteli Vidalalı Hidrolik Çektirme Seti

8 Ton Capacity Hydraulic Puller Kit



Ürün Kodu: FMK800

- » 2 kollu kısa çapraz çekirtilme
- » 2 kollu uzun çapraz çekirtilme
- » 2 kollu rulman kasnak çekirtilme
- » 2 kollu ay tip kısa rulman çekirtilme
- » 2 kollu ay tip rulman çekirtilme uzatması
- » 2/3 kollu standart tip dıştan çekirtilme

Product Code: FMK800

- » 2 jaws short type cross puller
- » 2 jaws long type cross puller
- » 2 jaws bearing puller
- » 2 jaws moon type short bearing puller
- » 2 jaws moon type bearing puller extension
- » 2/3 jaws standard type external puller



Aşağıda yer alan tüm ürünler ayrı ayrı sipariş edilebilir. *All products listed below can be ordered separately.*

Ürün Kodu: 1010H

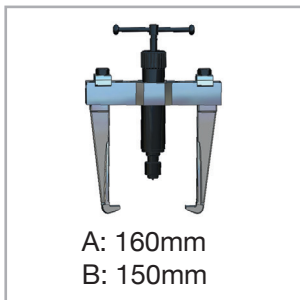

Ürün Kodu: 1010H SP

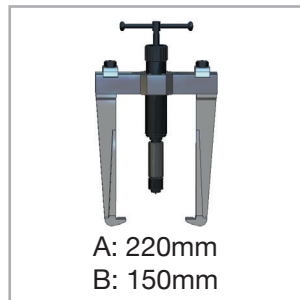

1008AH + 1204

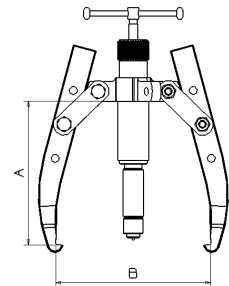
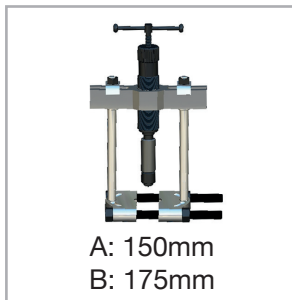

1008AH + 1204

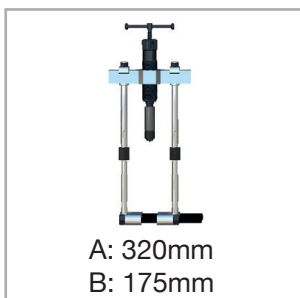

Ürün Kodu: 1308



Ürün Kodu: 1308TH



Ürün Kodu: 1204B

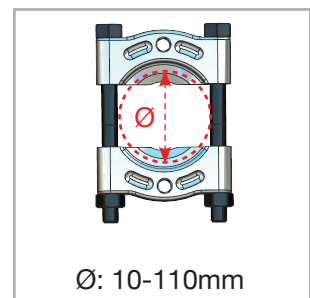



8 Ton Kapasiteli Vidalı Hidrolik Çektirme Seti

8 Ton Capacity Hydraulic Puller Kit

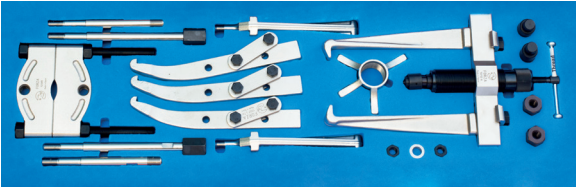

Genel Kullanım Talimatı:

- » Çektirmenin vidalı milini temiz tutunuz. Mili belli aralıklarla gresleyiniz.
- » Vidalı pistonu el ile çeviriniz. El kuvveti ile 8 tonluk hidrolik gücü kolayca üretebilirsiniz.
- » Çektirme milini işlem sırasında yataklayarak merkezleyiniz.
- » Çenelerin ve uzatma millerinin iyice merkezlendiğinden emin olunuz
- » Vidalı çektirme miline çekiçle asla vurmayınız.
- » Çektirme işlemi yaparken uygun iş elbiseleri giyip, koruyucu ekipmanlarınızı kullanınız.

General Use Instructions:

- » Keep the spindle cleaned and greased.
- » Do not use a lever by activating hydraulic ram.
- » Hydraulic ram handle has the proper length for pulling up to 8 Tons.
- » If the shaft has not a center point, remove the point protector from the spindle.
- » Be sure the jaws/extenders are properly centered.
- » Never hit the spindle while you are using the puller.
- » Always wear suitable personal protective equipment.

Set İçeriği / Kit Includes

Ürün Kodu: 1010H

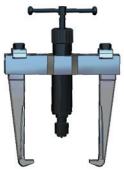

A: 160mm
B: 150mm

Ürün Kodu: 1010H SP

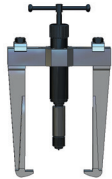

A: 220mm
B: 150mm

1008AH + 1204

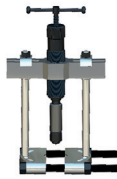

A: 150mm
B: 175mm

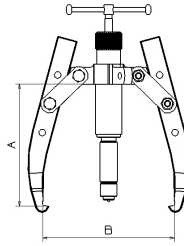

1008AH + 1204



A: 320mm
B: 175mm

Ürün Kodu: 1308



A: 225mm
B: 240mm

Ürün Kodu: 1308TH



A: 225mm
B: 240mm

Ürün Kodu: 1204B

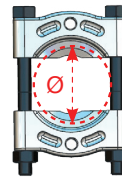

Ø: 10-110mm



Kasnak-Rulman Çektirme Talimatı:

Kasnak, ve rulman yarım ay çenelere olabildiğince en yakın konumda olmalıdır. (Şekil A)

Ayırıcı çene daima düz tarafta kullanılmalıdır. (Şekil B)

Boşluk varsa, ayırıcı çeneyi Şekil C deki gibi kullanın. Kasnak yerinden oynadıktan ve boşluk açıldıktan sonra çeneleri ters çevirerek işleme devam edin. (Şekil D)

Fig. A

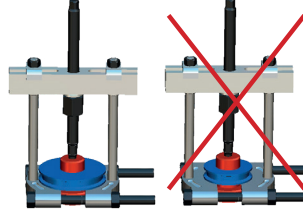

Fig. B

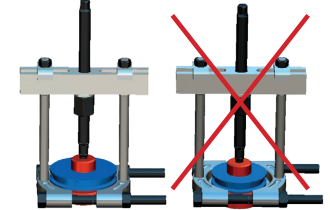

Fig. B

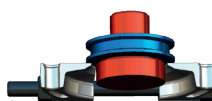

Fig. C

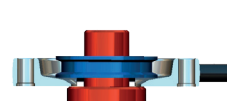
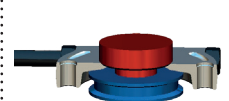

Fig. D



General use instructions for Splitters/Separators:

The pulley must be located as closest as possible to the extenders. (Fig. A)

The splitter must be used always on the flat side. (Fig B)

If there is a lack of space, use the splitter as (Fig C) and after having pulled and once there is space, inverse the splitter for continuing the extraction (Fig. D)