

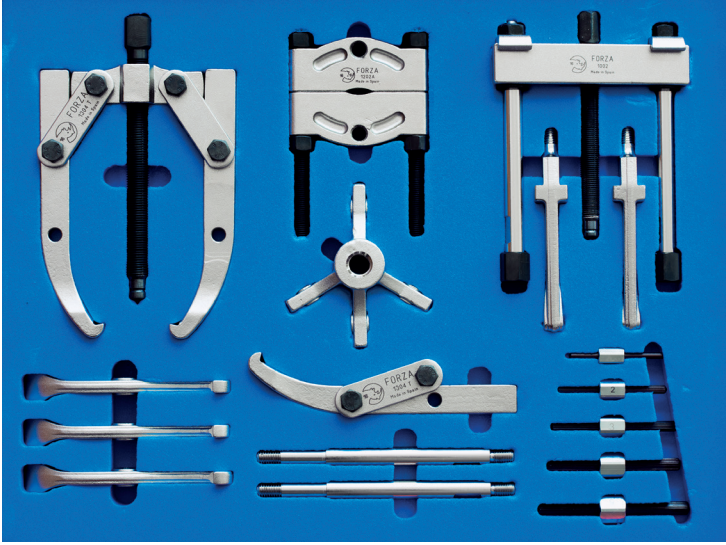

4 Ton Kapasiteli Mekanik Çektirme Seti

4 Ton Capacity Mechanical Puller Kit



Ürün Kodu : FMK400

- » 2 kollu kısa çapraz çektirme
- » 2 kollu rulman kasnak çakma
- » 2 kollu ay tip rulman - kasnak çektirme
- » 2/3 kollu standart tip içten çektirme
- » 2/3 kollu Standart tip dıştan çektirme
- » M6 - M20 saplama sökme milleri

Product Code: FMK400

- » 2 jaws short type cross puller
- » 2 jaws bearing pusher
- » 2 jaws moon type bearing puller
- » 2/3 jaws standard type internal puller
- » 2/3 jaws standard type external puller
- » M6 - M20 broken bolt extractor

Aşağıda yer alan tüm ürünler ayrı ayrı sipariş edilebilir.
All products listed below can be ordered separately.

Ürün Kodu : 1002

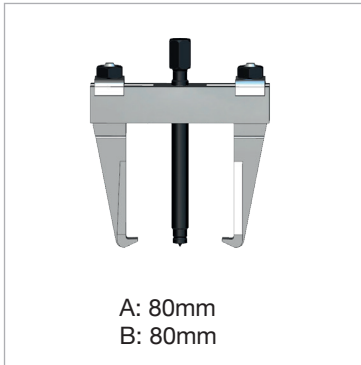

Ürün Kodu : 1102



Ürün Kodu : 1202A

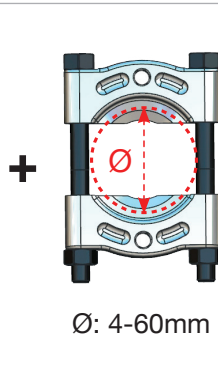

1102+1202A

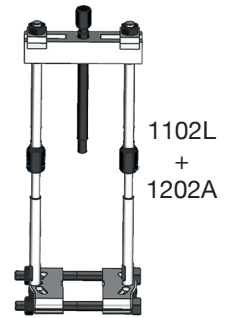
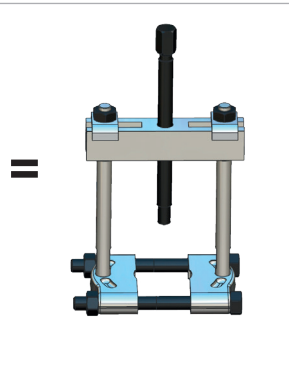

Ürün Kodu : 1304



Ürün Kodu : 1304T

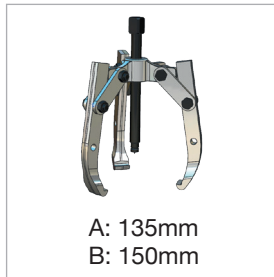

Ürün Kodu : 1404

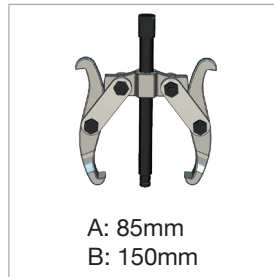

Ürün Kodu : 1404T

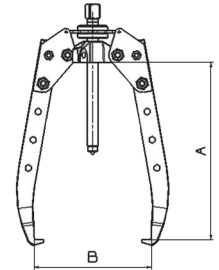
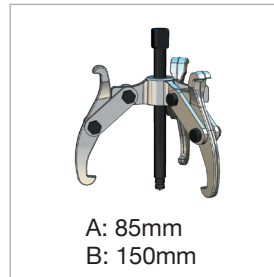

Ürün Kodu : 5010

M6-M20



Saplama Çektirme Milleri

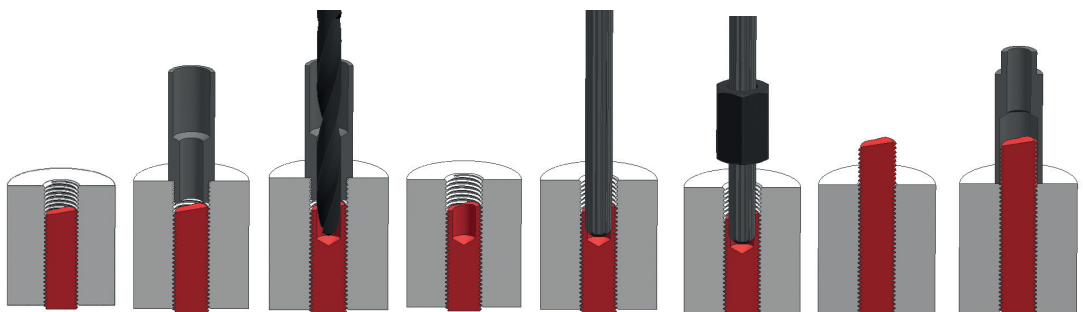



4 Ton Kapasiteli Mekanik Çektirme Seti

4 Ton Capacity Mechanical Puller Kit

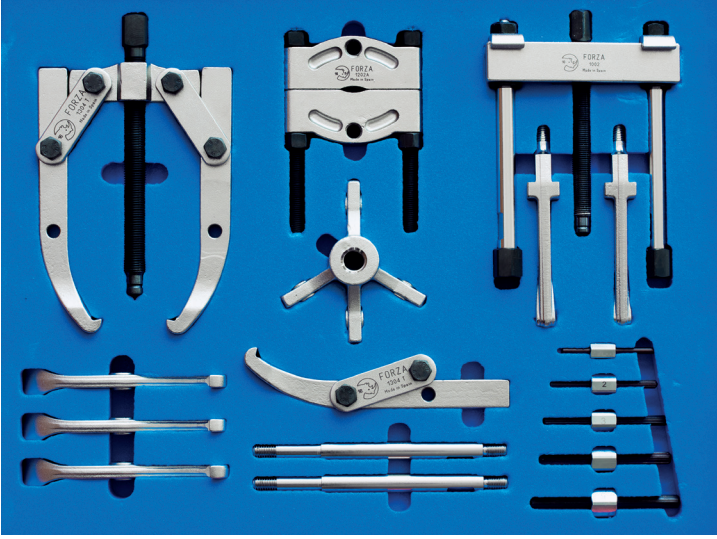

Genel Kullanım Talimatı:

- » Çektirmenin vidalı milini temiz tutunuz. Belli aralıklarla mili gresleyiniz.
- » Mil ucunu kasmağın merkezindeki deliğe kaymayacak şekilde oturtunuz.
- » Çektirme çenelerinin dengeli ve eşit olarak yerleştiriniz
- » Ana mili uygun anahtar ile çevirerek çektirme işlemini başlatınız
- » Mili çevirmek için havalı veya elektrikli alet kullanmayınız
- » Vidalı çektirme miline çekiçle asla vurmayınız.
- » Çektirme işlemi yaparken koruyucu ekipmanlarınızı kullanınız.

General Use Instructions:

- » Make sure the spindle is cleaned and greased before use.
- » Make sure the axle has a centre hole. If not use a point protector.
- » Make sure the jaws are evenly spread.
- » Apply pulling force by turning the spindle.
- » Never hit the spindle and not use power impact wrench.
- » Do not keep the spindle too sticking out from the puller's body.
- » Always wear suitable personal protective equipment.

Set İçeriği / Kit Includes

Ürün Kodu : 1002

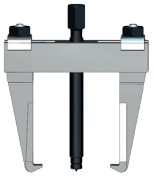

A: 80mm
B: 80mm

Ürün Kodu : 1102



A: 120mm
B: 110mm

Ürün Kodu : 1202A

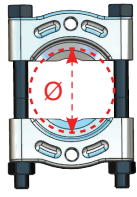

Ø: 4-60mm

1102+1202A

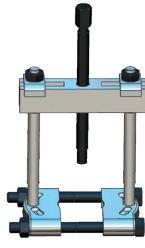

1102L
+
1202A



Ürün Kodu : 1304

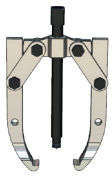

A: 135mm
B: 150mm

Ürün Kodu : 1304T

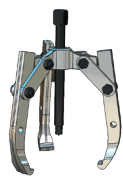

A: 135mm
B: 150mm

Ürün Kodu : 1404

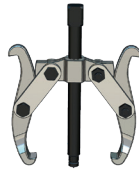

A: 85mm
B: 150mm

Ürün Kodu : 1404T

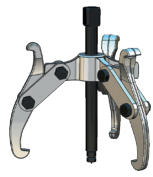

A: 85mm
B: 150mm

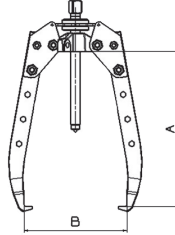

Kasnak- Rulman Çektirme Talimatı:

Kasnak, ve rulman yarım ay çenelere olabildiğince en yakın konumda olmalıdır. (Şekil A)

Ayrıcı çene daima düz tarafta kullanılmalıdır. (Şekil B)

Boşluk varsa, ayrıcı çeneyi Şekil C'deki gibi kullanın.

Kasnak yerinden oynadıktan ve boşluk açıldıktan sonra çeneleri ters çevirerek işleme devam edin. (Şekil D)

Fig. A

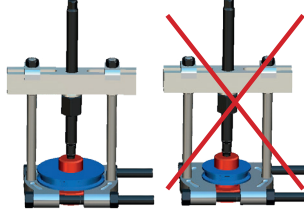

Fig. B

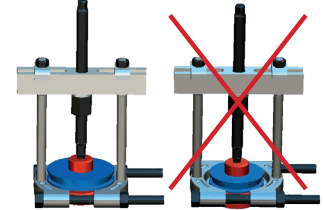

Fig. B

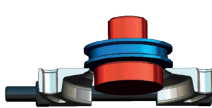
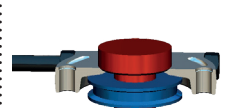

Fig. C



Fig. D



General use instructions for Splitters/Separators:

The pulley must be located as close as possible to the extenders. (Fig. A)

The splitter must be used always on the flat side. (Fig B)

If there is a lack of space, use the splitter as (Fig C) and

after having pulled and once there is space, inverse the splitter for continuing the extraction (Fig. D)